

Specifications

- Width: 16.00m
- Minimum Length: 2.50m
- Extension (unlimited): 2.50m
- Side height: 2.50m
- Peak height: 7.17m
- Bay distance: 2.50m
- Snow load: 100 kg/m²
- Wind load: 100 km/h

Structure: European – hard pressed extruded structural aluminium
 Main profile Size: 94 / 48 / 3 mm (4 Channel)
 Connection components: European – hot dipped, structural grade corrosive resistant galvanised steel
 Covering: Robust industrial grade PVC, 650g/m² coated polyester fabric. Flame retardant according to DIN 4102 B1, M2 BS 5438/7837, USA NFPA701

Packaging Dimensions
 Standard Tent (16.00m x 22.50m)
 Longest part: 3.60m
 Weight (approx.): 5,600.00 kg
 Transport dimensions: 1 x 20 ft Container

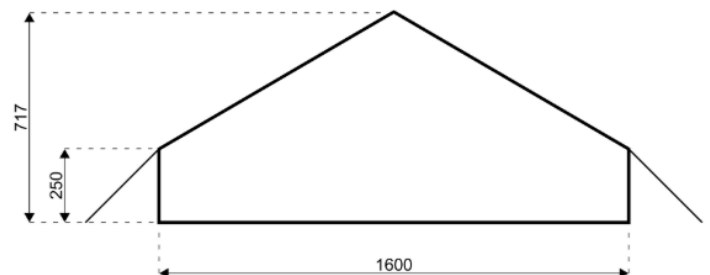
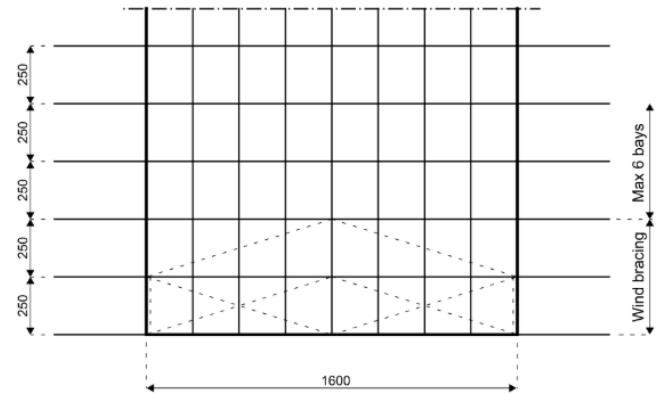
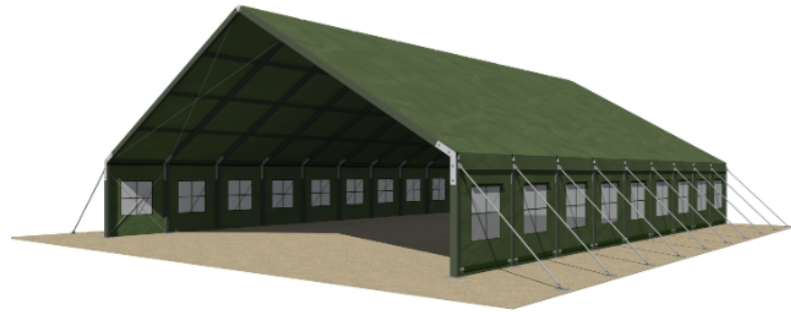



STRUCTURE FEATURES

- Frame made from extruded 4-channel-Profiles
- Galvanised steel plate eave and ridge connector
- Each front and rear bay with 2 gable uprights
- Base plates made from Steel – S235
- Purlins made from extruded aluminium profiles
- Including set up equipment
- Ground anchors made from steel, galvanised



COVER FEATURES

- Usable from both sides
- One door on each gable side/ end field (1.20 m x 2.10 m)
- Side marquees optional with windows in the central position, each window with welded mosquito netting, Transparent flap and outer flap
- Pipelines for HVAC and cables systems
- Mudflap fixed at covers end
- Mudflap made from PVC, same colour as the roof cover
- High frequency welded
- Waterproof
- Putrefaction-restraining (anti-fungicidal)
- Bar tensioned
- Packbags for each cover part of the tent, bags made from PVC Material

COVER SPEC

- Type of coating: PVC
- Finish: UV-protected
- Standard colour outside: Outside olive-green – RAL 6031
- Standard colour inside: White
- High-quality PVC: 650 gr/ sqm – EN ISO 2286-2
- Tensile strength – warp/ weft: 2500 / 2500 N/5cm – EN ISO 1421/V1
- Tear resistance – warp/ weft: 250 N / 250 N – DIN 53363
- Adhesion: 20 N/cm – PA 09.03
- Cold resistance: – 40 °C – EN 1876-1
- High Temperature: +70 °C – PA 07.04
- Light fastness: >6 Note, Value – EN ISO 105 B02
- Crack resistance: 100000 x – DIN 53359 A
- Yarn count: 1100 dtex – ISO 2060
- Flame retardant according to BS 7837, California T 19, D.M. 26.06.84 (UNI9177): CL. 2, DIN 4102: B1, NFP 92507: M2, NFPA 701 Test 2, EN 13501-1: B-s2-d0



TYPES OF ACCESSORIES

- Sunshade cover and insulation liners for better climate inside the tent
- Different types of flooring systems available
- Electrical equipment (Distribution boxes, lighting systems, cables...)
- Heating, ventilation, air conditioning – System (HVAC)
- Complete camp solution, including supply, installation, maintenance and much more.
- Röder HTS Höcker GmbH provides an unlimited range of accessories to support its range of military and relief shelter systems.